

FRONT END LOAD CONTAINERS



FRONT END LOAD CONTAINERS

FLAT TOP

6 YARD FLAT

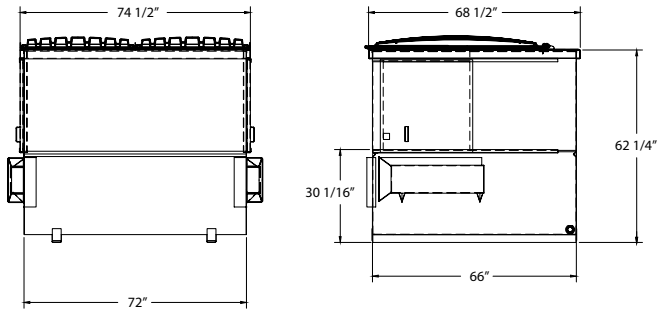

8 YARD FLAT

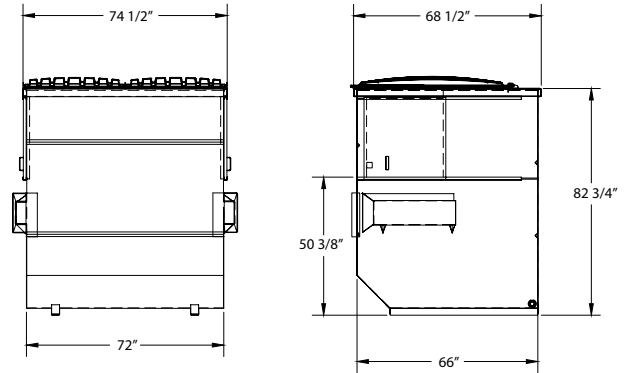

10 YARD FLAT

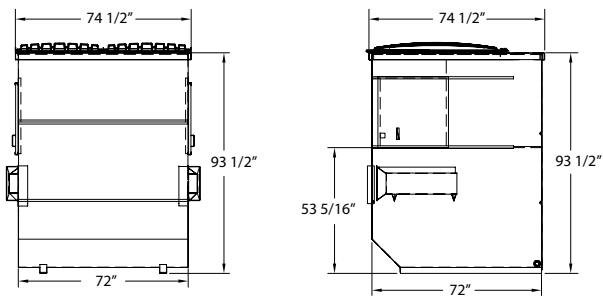

STANDARD

- Fully Welded Interior Seams, Lift Pockets, & Support Gussets 3" x 1.5" Banded Top Perimeter
- 10GA. Formed Lift Pocket
- 3-3" Structured Channel Skids on 6 & 8 Yards
- 12GA. Sides & Floors
- Quick-Release Caster on 2-4 Yard Containers
- Double & Single Wall Plastic Lids
- Drain Plugs

OPTIONAL FEATURES

- Auto or Manual Lockbars
- Bottom Lift Pockets Casters
- Heavy / Light Duty Rubberized
- Coating Wildlife Resistant
- Tops Screen Recycling Fronts

	6 YARD	8 YARD	10 YARD
48FT. Trailer Flat / Drop	8 / 14	8 / 8	7 / 7
53FT. Trailer Flat / Drop	9 / 16	9 / 9	8 / 8
Plastic Lid Standard	37" x 58" Single Wall	37" x 58" Single Wall	37" x 58" Single Wall
Sides	12 Gauge	12 Gauge	12 Gauge
Bottom	12 Gauge	12 Gauge	12 Gauge

FRONT END LOAD CONTAINERS

SLANT TOP

2 YARD SLANT NESTABLE

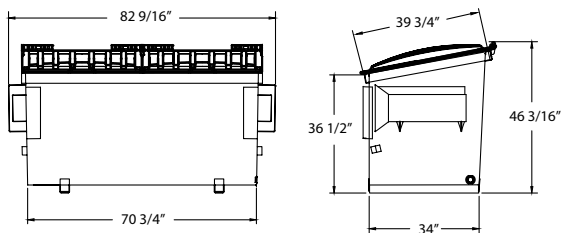

6 YARD SLANT

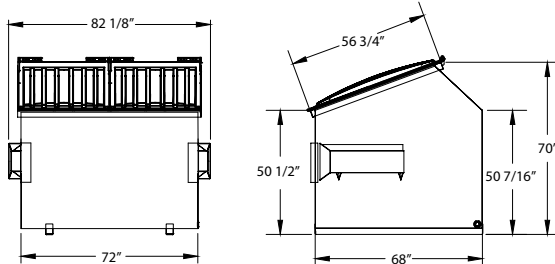

3 YARD SLANT NESTABLE

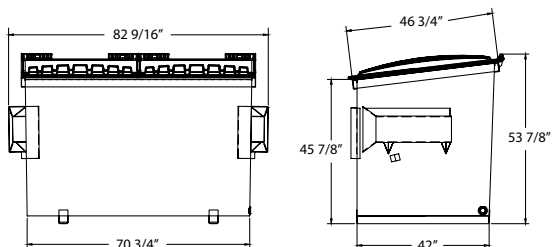

8 YARD SLANT

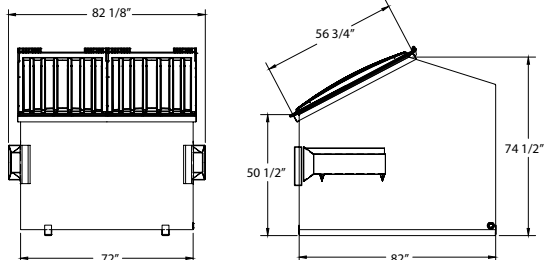

4 YARD SLANT NESTABLE

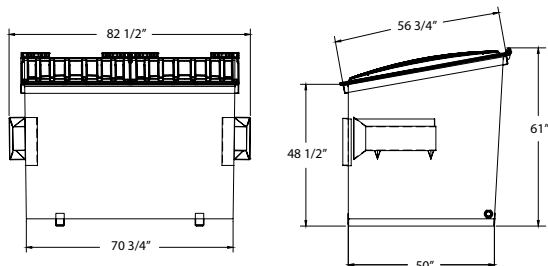

	2 YARD*	3 YARD*	4 YARD	6 YARD	8 YARD	10 YARD
48FT. Trailer Flat / Drop	36 / 42	28 / 36	14 / 25	8 / 14	7 / 7	7 / 7
53FT. Trailer Flat / Drop	42 / 56	42 / 56	16 / 28	8 / 14	8 / 8	8 / 8
Plastic Lid Standard	37" x 41" Single Wall	37" x 48" Single Wall	37" x 58" Single Wall	37" x 58" Single Wall	37" x 58" Single Wall	37" x 58" Single Wall
Sides	12 Gauge	12 Gauge	12 Gauge	12 Gauge	12 Gauge	12 Gauge
Bottom	12 Gauge	12 Gauge	12 Gauge	12 Gauge	12 Gauge	12 Gauge

* Nestable

Standard Color Choices

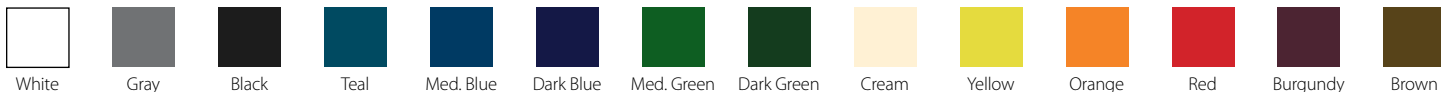

Colors shown are as accurate as printing allows. The actual color is subject to variation from the printed color sample. Color choices vary by plant location. Please contact your local sales representative for available colors. Custom colors are available upon request and are subject to an additional charge.



602-313-8075

www.SuperiorContainerSolutions.com

Superior Container Solutions. All rights reserved. Specifications subject to improvement without notice. Operators should become familiar with OSHA, ANSI, and any other applicable standards or laws for using this equipment. Improper use, misuse, or lack of maintenance could cause injury to people and/or property. Photos used in literature are illustrative only.

We assume no liability or responsibility for proper training/operation of equipment not manufactured by Superior Container Solutions. We reserve the right to make changes at any time without notice. Information contained within this literature is intended to be the most accurate available at the time of printing.